

Item: M15-12751-BLD

Description: XPS1530/SSAAA/TWS/TF/STF/0504 + Ball lift device



Residual emptying of WILDEN air driven diaphragm pumps

The ball lifters allow the pump and pipeline to be emptied when installed. Ball lifters are attached to the four product valves. By turning the toggles by approx. 30° to a maximum of 180°, the valve balls are lifted from their seats and the

The pump runs empty on the suction side. The entire line system on the pressure side can also be emptied or backwashed to the suction side. When closed, the ball lifters must point vertically downwards

ATTENTION: Before lifting the valve balls, the pressure-side piping is just after shut off the pump. If the valve balls are in the uppermost position, the pressure-side pipeline can be opened for drainage.

ATTENTION: After emptying the pump, make sure that the ball lifters are returned to their original position, vertically downwards.

Starting the pump with the valve balls lifted will cause the pump to run dry.

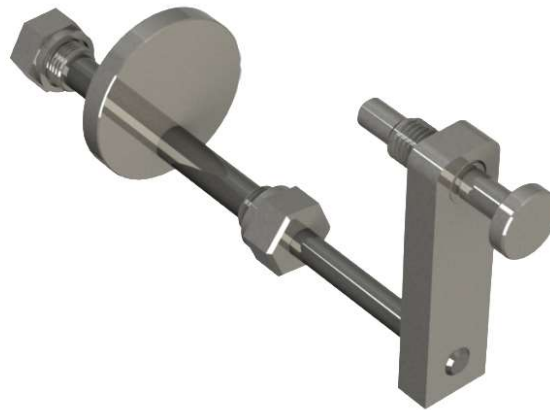

BALL LIFTING DEVICE
QTY PER PUMP: 4
QTY PER KIT: 4
PART NUMBER KIT: MA200142



For maintenance work, it is recommended to change the O-rings every time the kits are disassembled.

All the O-rings used to assemble the 4 ball lifting devices are grouped together in the kit:
MA200142-GKT

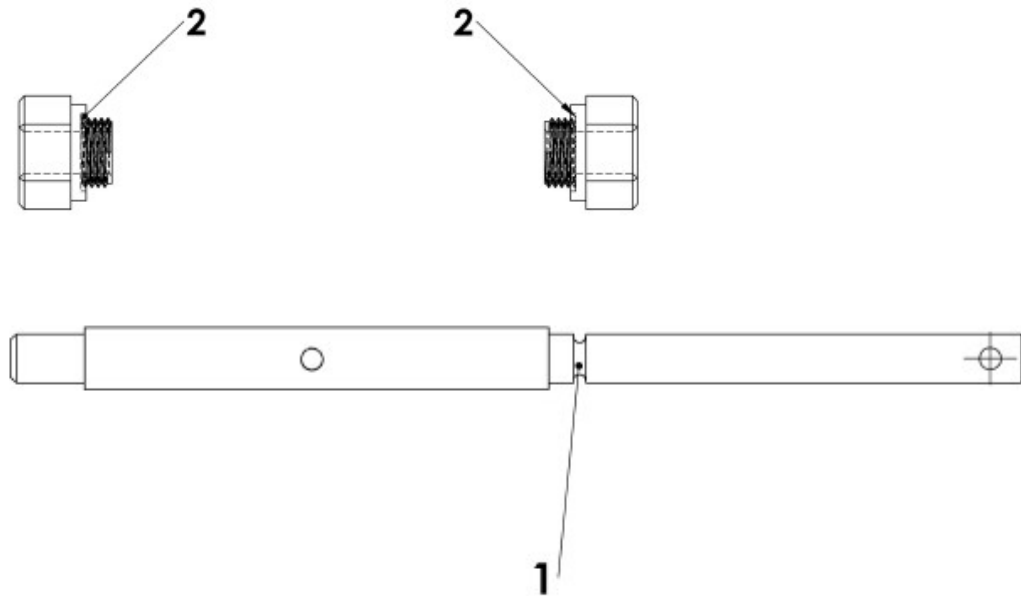

POS	Description	QTY PER SHAFT	QTY PER KIT
1	FKM O-Ring 5x1,8	1	4
2	FKM O-Ring 10 x1,5	2	8

